

Insulating Assemblies

A comprehensive range of nylon insulating assemblies are available to suit those installations where there is a requirement to provide electrical separation between the Speedway Cable Ladder System and the support structure.

A typical example is a stainless steel Speedway Cable Ladder System mounted on galvanised or painted steel supports.

The insulating assembly is based on nylon base pads, nylon bushes and nylon washers which, when used with the Speedway External Flange Clamp, the Speedway Adaptable Fixing Bracket, or the Speedway Hold Down Bracket totally encapsulate the fixings and provide an insulation barrier between the Speedway Cable Ladder System and the supporting structure.

M10 Nylon Bush

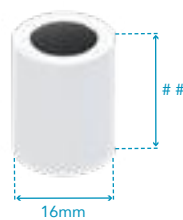

315AN01-##: Nylon Bush Length ## = Steel Thickness (mm)

The length of the nylon bush is equal to the thickness of the supporting steelwork (##). The nylon bush requires a 17mm diameter hole in the supporting steelwork.

M10 Fixing Bolt

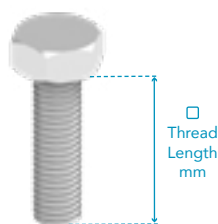

The minimum thread length for the fixing bolt (□) is 22mm plus the thickness of the supporting steelwork(##). Refer to the table below for details of the fixing bolts.

| Part Number | Thread Length (□) | Description |
|-----------------|-------------------|---|
| M10x25-HS-SS-A4 | 25mm | M10 x 25 Hex Head Set Screw Stainless Steel |
| M10x30-HS-SS-A4 | 30mm | M10 x 30 Hex Head Set Screw Stainless Steel |
| M10x35-HS-SS-A4 | 35mm | M10 x 35 Hex Head Set Screw Stainless Steel |
| M10x40-HS-SS-A4 | 40mm | M10 x 40 Hex Head Set Screw Stainless Steel |

Insulating Assembly Components for External Flange Clamp (EFC)

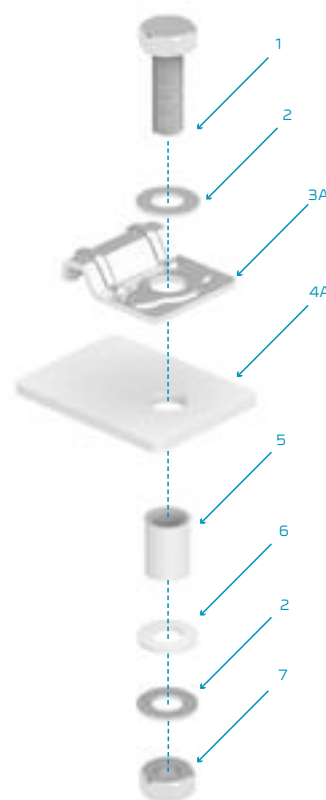

| Part Number | Item | Description |
|------------------|------|---|
| M10x□-HS-SS-A4 | 1 | M10 Hex Head Set Screw Stainless Steel - Length = □ |
| M10-FW-SS-A4 | 2 | M10 Flat Washer Stainless Steel |
| SW-EFC-SS | 3A | Speedway External Flange Clamp Stainless Steel |
| PAD-66.5x50x4-NY | 4A | Nylon Pad (66.5 x 50 x 4mm) |
| BUSH-16x##-NY | 5 | Nylon Bush - Length = ## |
| M10-FW-NY | 6 | M10 Flat Washer Nylon |
| M10-HN-SS-A4 | 7 | M10 Hex Nut Stainless Steel |

For Example:

If the thickness of the Steelwork = 12mm
The length of the Nylon Bush is also 12mm = 315AN01-12
This means that the Minimum Thread Length of the Fixing Bolt = 22 + 12 = 34mm
Rounding this figure up to the nearest standard bolt length of 35mm,
the supplied bolt = SSM10x35HS
If an AFB is to be used, order: SW-AFB-SS-INS12

Insulating Assembly Components for Adaptable Fixing Bracket (AFB)

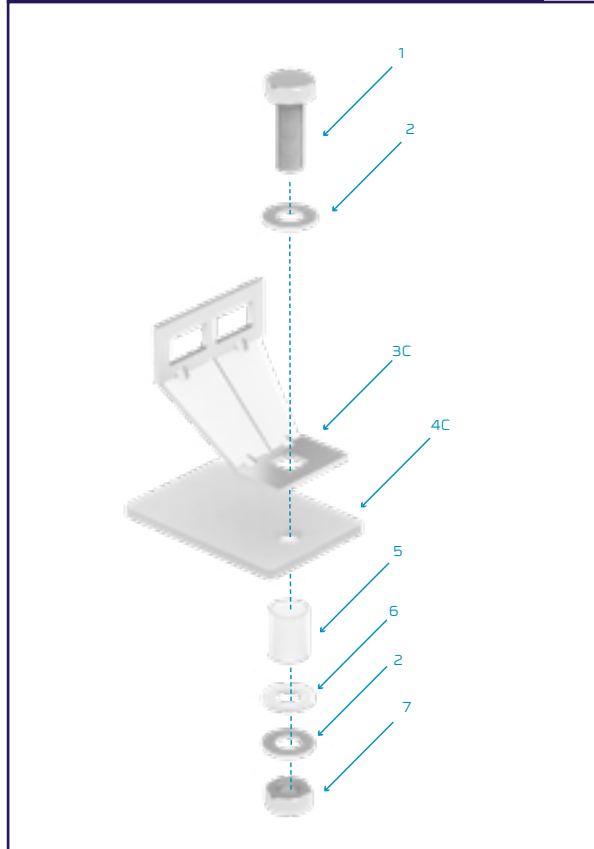

| Part Number | Item | Description |
|----------------|------|---|
| M10x□-HS-SS-A4 | 1 | M10 Hex Head Set Screw Stainless Steel - Length = □ |
| M10-FW-SS-A4 | 2 | M10 Flat Washer Stainless Steel |
| SW-AFB-SS | 3C | Speedway Adaptable Fixing Bracket (AFB) |
| PAD-80x55x4-NY | 4C | Nylon Pad (80 x 55 x 4mm) |
| BUSH-16x##-NY | 5 | Nylon Bush - Length = ## |
| M10-FW-NY | 6 | M10 Flat Washer Nylon |
| M10-HN-SS-A4 | 7 | M10 Hex Nut Stainless Steel |

Insulating Assembly Components for Hold Down Bracket (HDB)

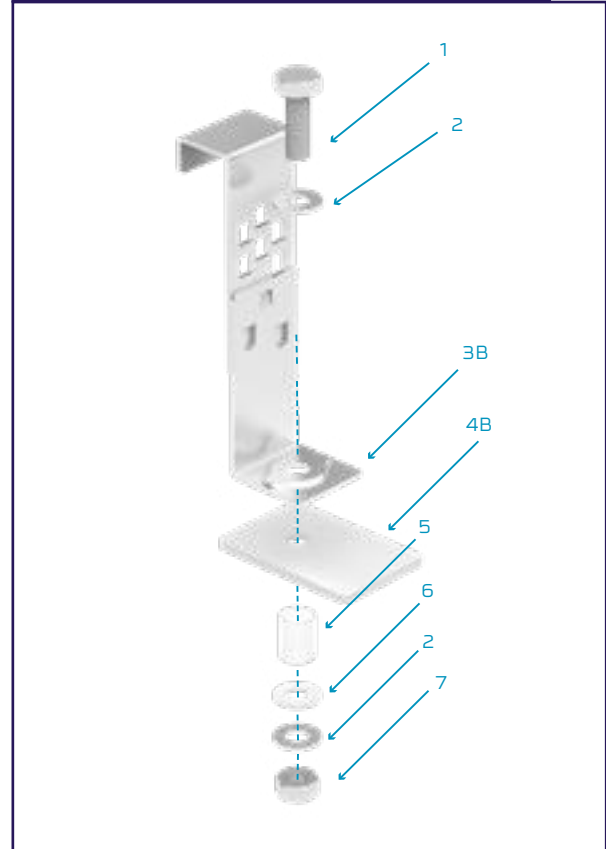

| Part Number | Item | Description |
|----------------|------|---|
| M10x□-HS-SS-A4 | 1 | M10 Hex Head Set Screw Stainless Steel - Length = □ |
| M10-FW-SS-A4 | 2 | M10 Flat Washer Stainless Steel |
| SW-HDB-SS | 3B | Speedway Hold Down Bracket Stainless Steel |
| PAD-75x50x4-NY | 4B | Nylon Pad (75 x 50 x 4mm) |
| BUSH-16x##-NY | 5 | Nylon Bush - Length = ## |
| M10-FW-NY | 6 | M10 Flat Washer Nylon |
| M10-HN-SS-A4 | 7 | M10 Hex Nut Stainless Steel |